

# 6-FM-9Ah

## Valve-regulated Lead Acid Battery Specification

### Features

- Maintenance free
- Safety and no leakage
- Excellent recharge and discharge performance
- Low self-discharge rate
- Adapt to high or low temperature
- Good deep discharge performance
- Longer cycle life



### Specification

Rated Voltage	12V
Numbers of cells	6 Cells
Capacity	9Ah@20hr-rate to 1.80V per cell @25°C
Weight	2.7kg
Internal Resistance	Approx. 23 mΩ
Terminal	F1 / F2
Max. Discharge Current	135A(5s)
Short Circuit Current	450A
Max. Charging Current	2.7A
Reference Capacity	C20 9AH C5 8.3AH C1 5.89AH
Design Life	6~8 years
Float Charging Voltage	13.6 V~13.8 V @ 25°C Temperature Compensation: -20mV/°C/Cell
Cycle Use Voltage	14.4 V~14.9 V @ 25°C Temperature Compensation: -30mV/°C/Cell
Operating Temperature Range	Discharge: -15°C~50°C Charge: 0°C~40°C Storage: -15°C~40°C
Normal Operating Temperature Range	25°C±5°C
Self Discharge	Less than 3% at 25°C per month
Container Material	A.B.S. UL94-HB, UL94-V0 Optional.

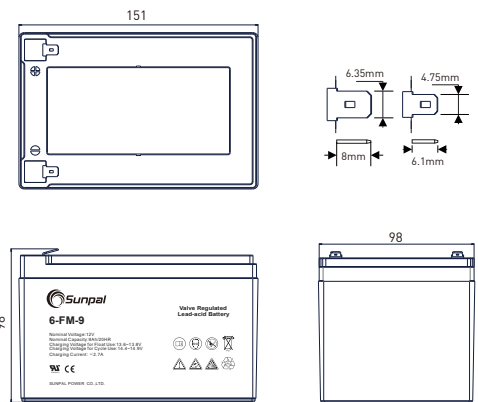

Length	151±2mm (5.9 inches)
Width	98±1mm (3.9 inches)
Height	94±1mm (3.7 inches)
Total Height	98 ±1mm (3.9 inches)

### Constant Current Discharge Characteristics: A(25°C)

F.V/Time	5min	10min	15min	20min	30min	45min	1h	3h	5h	10h	20h
1.80V/cell	25.60	18.70	14.60	12.40	9.56	6.94	5.63	2.50	1.66	0.93	0.450
1.75V/cell	28.80	20.50	16.00	13.30	9.92	7.20	5.89	2.55	1.70	0.96	0.505
1.70V/cell	31.70	22.40	17.10	14.00	10.30	7.49	6.08	2.62	1.74	0.97	0.514
1.65V/cell	35.00	24.20	18.10	14.90	10.90	7.68	6.22	2.73	1.79	0.99	0.521
1.60V/cell	38.60	26.20	19.40	15.80	11.50	8.00	6.28	2.82	1.85	1.01	0.524

### Constant Power Discharge Characteristics: WPC(25°C)

F.V/Time	5min	10min	15min	20min	30min	45min	1h	3h	5h	10h	20h
1.80V/cell	46.20	34.10	26.90	23.00	17.90	13.20	10.80	4.85	3.23	1.84	0.989
1.75V/cell	51.00	36.90	29.10	24.50	18.50	13.60	11.30	4.92	3.31	1.88	0.998
1.70V/cell	54.60	39.30	30.60	25.60	19.10	14.10	11.60	5.05	3.38	1.92	1.015
1.65V/cell	59.40	42.00	32.30	26.90	20.00	14.30	11.80	5.24	3.47	1.96	1.027
1.60V/cell	64.00	44.60	34.00	28.40	21.00	14.80	11.80	5.38	3.57	1.98	1.032

# 6-FM-9Ah

## Valve-regulated Lead Acid Battery Specification

### Charge Characteristics for Float Use @ 25°C/77°F

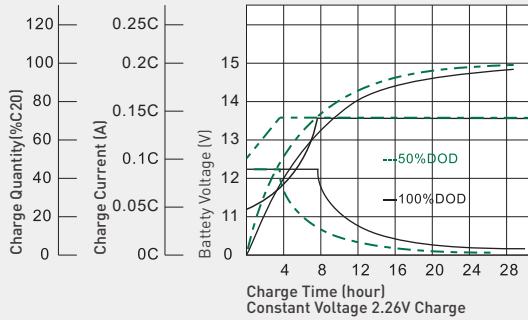

### Discharge Characteristics at Various Rates @ 25°C/77°F

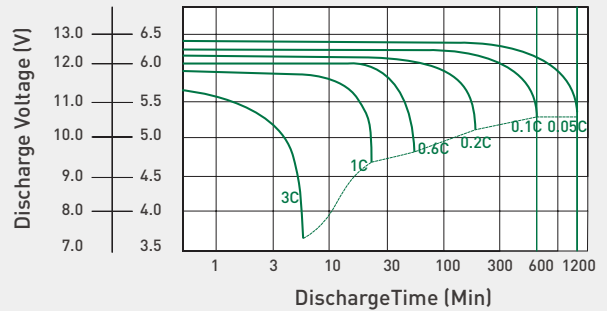

### Cycle Life in Relation to Depth of Discharge

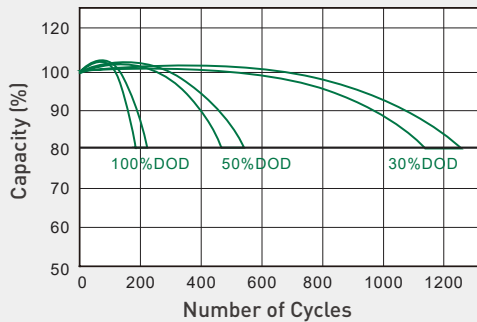

### Float Service Life

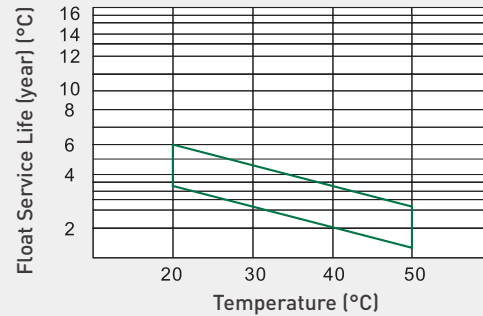

### Temperature and Valid Capacity

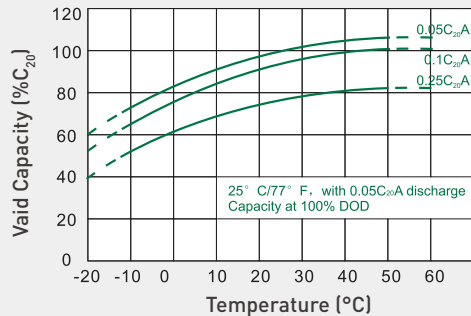

### Self Discharge Characteristics

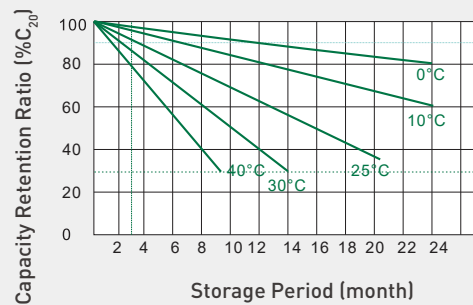

### Capacity and Open Circuit Voltage

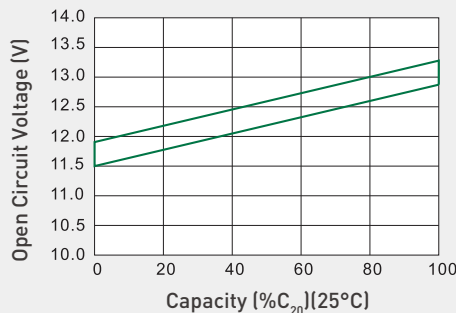

### Relationship between Charging Voltage and Temperature

